



Examination Light

Super Exam LED

A combination of flexible drift-free positioning, excellent light output and LED energy-saving technology.



burton®

Examination Light

Super Exam LED

User-friendly and exceptional performance.

Delivering superior illumination to a focused area, Burton's Super Exam LED light is ideal for general examination.

Usability

- Flexible and precise covered spring-balanced arm is easy to position exactly where light is required
- The power and dimming switch is positioned near the handle for one-handed operation
- Easy access handle designed for quick positioning

Performance

- High performing energy efficient LED components are virtually maintenance free
- Recessed LED light source to reduce glare
- Fully dimmable for the perfect amount of light
- Industry leading 5-year warranty
- Night light, low light output mode to prevent disturbing patients

Construction

- SteriTouch® coating inhibits the growth of bacteria
- Powder-coated metal construction for durability
- Light source covered with tempered glass
- Smooth surface design for easy wipe down with hospital-grade disinfectants

Floor and Table



Horizontal Movement

(left): Designed for maximum movement in the horizontal plane. Typical applications: Floorstand, table mounted.

Vertical Movement

(right): More vertical movement than arms found on large examination lights. The arm will always tilt forward to avoid collisions with the wall. Typical applications: Wall mounted, ceiling mounted.

Wall and Ceiling





Drift-free K-arm provides better positioning than goosenecks and is easier to clean

Table Mount Model



Floor Stand



Ceiling Mount



Wall Mount

All models are sold complete with light and arm system. (Product images not to scale.)

Super Exam LED product dimensions

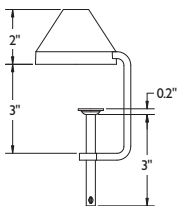
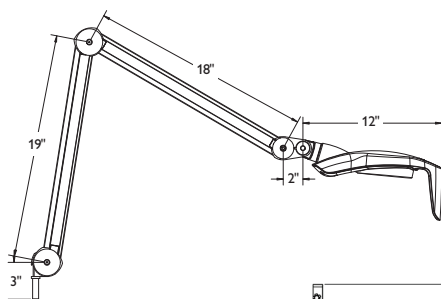
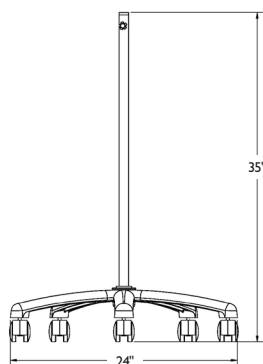
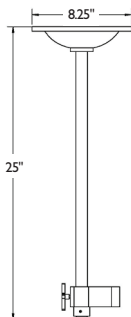

Table Mount



Floor Stand



Ceiling Mount:
• 8-9 ft. = 25"
• 10 ft. = 40"

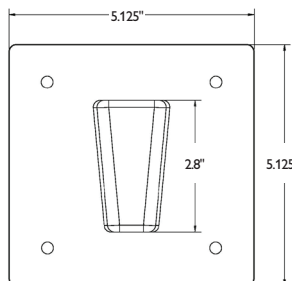

Wall Mount



Intuitive and ergonomic

The power and dimming switch is positioned near the handle for one-handed operation.



Dimming feature

The power button also serves as a dimming switch.



SteriTouch® antimicrobial powder coating

Prevents the growth of bacteria, biofilm and mold continuously throughout the product's lifetime.



Extremely energy efficient

Super Exam LED features a long lasting, energy-efficient LED light source with an incredible lifespan of 50,000 hours or more.

Summary of technical data

SUPER EXAM LED

| | |
|------------------------------|---|
| Illuminance: | 35,000 Lux (3251 fc) at 39.37" (1 m) |
| Color Temperature: | 4000 Kelvin |
| CRI (Color Rendering Index): | >95 |
| Light Source: | Light Emitting Diode (LED) |
| Rated Life: | 50,000-hour average LED life |
| Power: | 20 Watts |
| Mounting Options: | Single Ceiling Mount, Table Mount, Floor Stand and Wall Mount |
| Applications: | General examination |
| Certifications/Approvals: | ES 60601-1, IEC 60601-2-41, -1-6, EN 60601-1-2, CAN/CSA C22.2 NO. 60601-1 |
| Product warranty: | 5-year limited warranty |

Ordering Information

Note: The optical data are nominal values based on measurements calculated according to UL/IEC performance standards at 100v - 240v applications

SUPER EXAM LED

| Universal Input 100-240v 50-60Hz Model | | Universal Input 100-240v 50-60Hz Model | |
|--|---|--|-----------------------------------|
| | Description | | Description |
| SELEDFL | Super Exam LED Floor Stand | SELEDT | Super Exam LED Table Mount |
| SELEDFL01 | Super Exam LED Floor Stand EU | SELEDT01 | Super Exam LED Table Mount EU |
| SELEDFL02 | Super Exam LED Floor Stand AS/NZS | SELEDT02 | Super Exam LED Table Mount AS/NZS |
| SELEDFL03 | Super Exam LED Floor Stand UK | SELEDT03 | Super Exam LED Table Mount UK |
| SELEDC SELEDC10 | Super Exam LED Ceiling Mount | SELEDW | Super Exam LED Wall Mount |
| SELEDC01 | Super Exam LED 10 Ft Ceiling Mount | SELEDW01 | Super Exam LED Wall Mount EU |
| SELEDC0110 | Super Exam LED Ceiling Mount EU | SELEDW02 | Super Exam LED Wall Mount AS/NZS |
| SELEDC02 | Super Exam LED 10 Ft Ceiling Mount EU | SELEDW03 | Super Exam LED Wall Mount UK |
| SELEDC0210 | Super Exam LED Ceiling Mount AS/NZS | | |
| SELEDC03 | Super Exam LED 10 Ft Ceiling Mount AS/NZS | | |
| SELEDC0310 | Super Exam LED Ceiling Mount UK | | |
| | Super Exam LED 10 Ft Ceiling Mount UK | | |

| 100V Model | 230-240V* Models | Description | IEC Plug Type |
|------------|------------------|------------------------------|---------------|
| SELEDFL | SELEDFL*____ | Super Exam LED Floor Stand | |
| SELEDC | SELEDC*____ | Super Exam LED Ceiling Mount | |
| SELEDT | SELEDT*____ | Super Exam LED Table Mount | |
| SELEDW | SELEDW*____ | Super Exam LED Wall Mount | |

Where applicable, add appropriate Plug Type to the end of the model number. ¹



Example 1: SELEDW for a 100/120V Wall Model with Nema 5-15P Plug.

Example 2: SELEDFL02 for a 230/240V Floor Stand Model with AS/NZS 3112 Plug.

Example 3: SELEDC0310 for a 230/240v Ceiling Model with BS1363 plug and downtube for 10 Foot Ceiling.

¹ 100-120V Do not add Plug Type, NO CODE: NEMA 5-15P, 01: CEE 7/7, 02: AS/NZS 3112, 03: BS1363.

² 8" - 9" Ceilings are standard.

³ For 10' Ceiling applications, add 10 to Model number as shown in the example above.

Default (No Code):
NEMA 5-15P

01: CEE 7/7



02: AS/NZS 3112



03: BS1363



© 2018 Burton Medical. All rights reserved.
Burton Medical reserves the right to make changes in specifications and/or to discontinue any product at any time without notice or obligation and will not be liable for any consequences resulting from the use of this publication.

burton®

Burton Medical, LLC
2300 W Windsor Ct., Suite C
Addison, IL 60101 USA
Phone (800) 444-9909, Fax (800) 765-1770
Burtonmedical.com